



Headset Intercom System, Model C960

Instructions for Programming Headset and Replacing Top, Side and Ear Pads and Mic Windscreen

To program headset:

1. Pull outward on lower right side of base station cover. Lift and remove. (see figure 1).
2. Turn on base station. One of the red channel indicators (1-8) will light, indicating the selected channel.
3. Plug end of programming cable into base station programming jack (see figure 3).
4. Turn on headset. Plug flat end of programming cable into headset programming jack (see figure 2).
5. Audible tones will be heard in the earpiece, indicating that programming is complete. Headset is now programmed to same channel as base station.

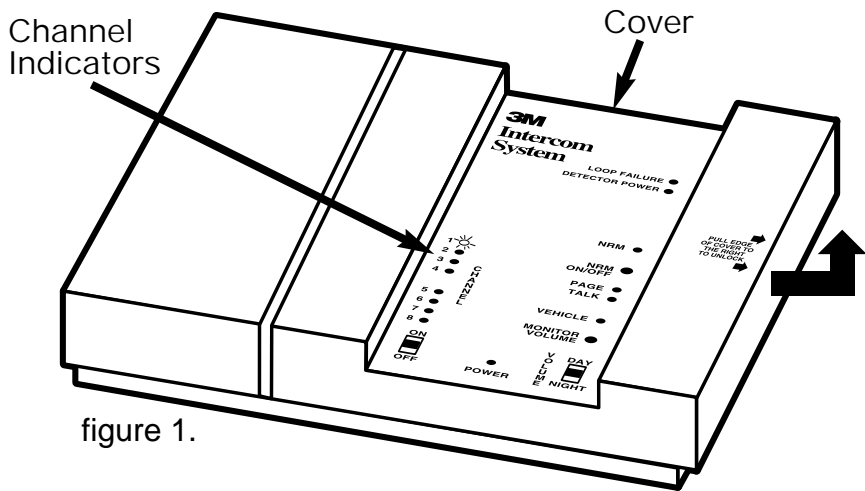

figure 1.

To replace side and top headset pads:

Side pads

1. Using a small screwdriver or coin, press in and down on pad clip (see figure 4) to remove old pad.
2. Snap new pad into place.

Top pad

1. Place a small screwdriver or coin at base of pad and pry upward (see figure 5).
2. Snap new pad into place.

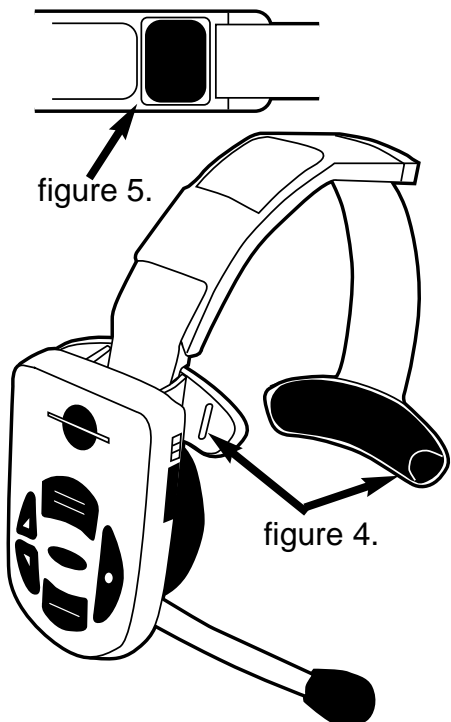

figure 5.

figure 4.

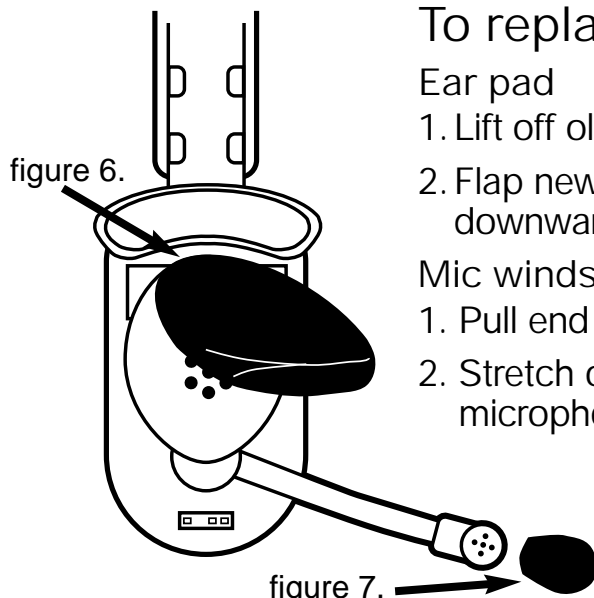

figure 6.

figure 7.

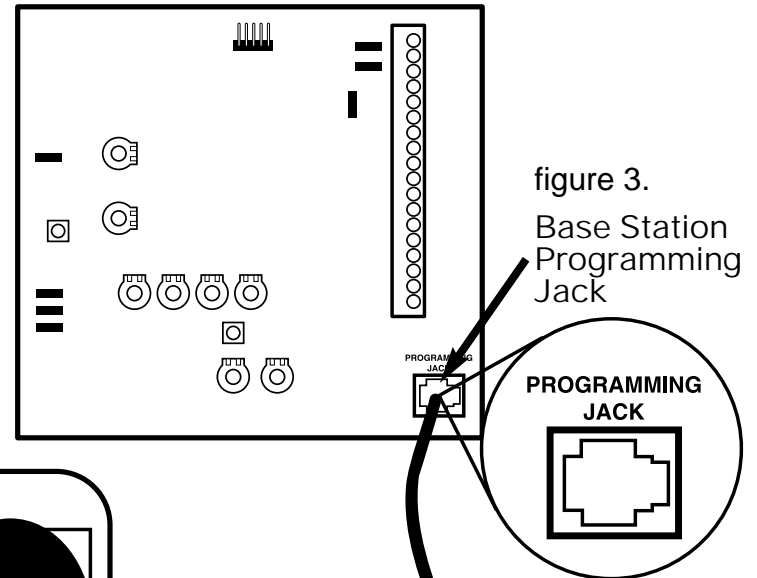

figure 3.
Base Station Programming Jack

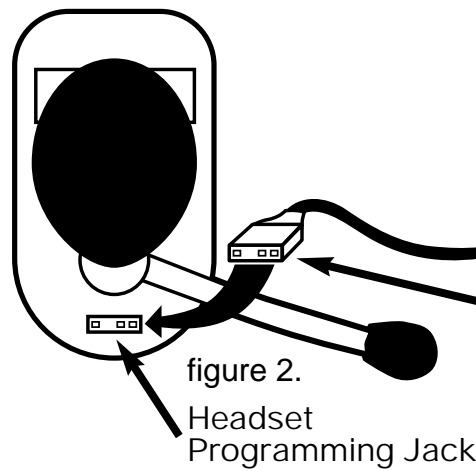
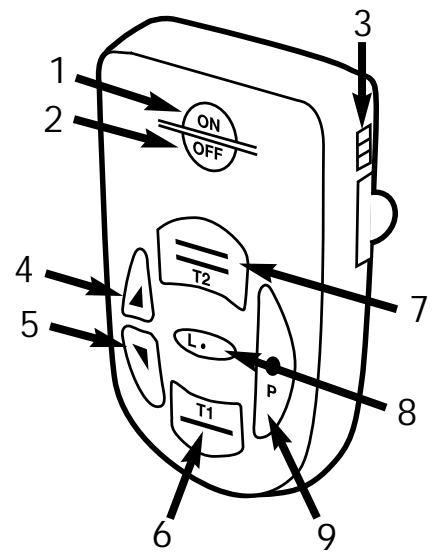

figure 2.

Caution: Make sure missing pin in headset is aligned with plugged position in programming cable.

Headset controls:

1. Turn on headset.
2. Turn off headset.
3. Push up to remove battery.
4. Increase volume.
5. Decrease volume.
6. Press to talk to customer in a single lane operation.
7. Press to talk to customer in lane 2 of a dual lane operation.
8. Press once to provide hands-free communication with customer. Press again to cancel.
9. Press to talk to internal personnel wearing a headset.



To replace ear pad and mic windscreen:

Ear pad

1. Lift off old ear pad.
2. Flap new ear pad over top of earpiece and pull downward, stretching to cover earpiece (see figure 6).

Mic windscreen

1. Pull end of old windscreen to remove.
2. Stretch opening of new windscreen and slide over microphone (see figure 7).

